

# Digital PD meter

## PD-5



# Precision mirror design with accurate digital readout of PD values.

## Topcon PD-5

### MAJOR FEATURES

- Corneal reflection coincidence system. Simply align the PD needle with the light reflected on the cornea for a fast and accurate.
- LCD display. Shows three measurement values: (R,R+L,L)
- 0.5mm measurement increments for precise valuation.
- Select measurement of one or both eyes.
- Measure fixation PD distance from 30 cm to infinity.
- Compensation knob allows easy examination by examiner who requires bifocal lenses.
- Integral power-saving function automatically cuts power one minute after an examination is completed.
- Simplified measurement of distance from corneal vertex to lens or frame.

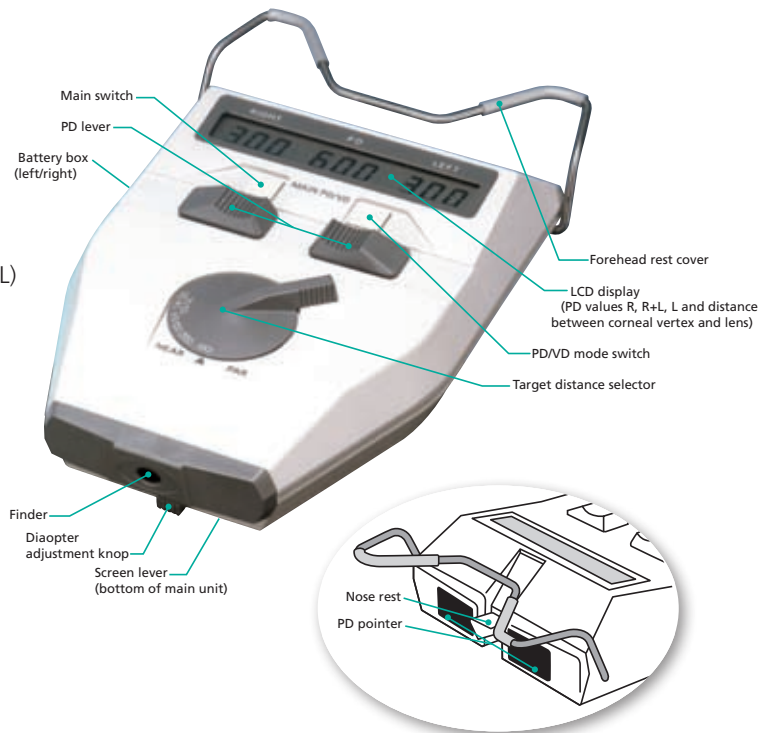

### Specifications

<b>Type of Measurement</b>	Corneal reflection coincidence
<b>PD Measurement Range</b>	46-82 mm in 0,5 mm increments 23-41 mm for single-eye measurement
<b>Display</b>	LCD digital readout
<b>Fixation target</b>	With internal illumination
<b>Viewing Distance</b>	~ to 30 cm, adjustable
<b>Diopter Adjustment</b>	Yes
<b>Single-Eye Shutter</b>	Yes
<b>Mode Selection</b>	PD/VD
<b>Illumination</b>	6 V, 0,3 W lamp
<b>Power Supply</b>	6 V DC (four AA batteries)
<b>Power Saving System</b>	Automatic shut-off mechanism
<b>Power consumption</b>	155 (W) x 255 (D) x 55 (H) mm
<b>Weight</b>	690 g



#### IMPORTANT

Subject to change in design and/or specifications without advanced notice.

In order to obtain the best results with this instrument, please be sure to review all user instructions prior to operation.

**Topcon Europe Medical B.V.**  
Essebaan 11; 2908 LJ Capelle a/d IJssel; P.O. Box 145;  
2900 AC Capelle a/d IJssel; The Netherlands  
Phone: (+31) 10 4585077; Fax: (+31) 10 4585045  
E-mail: medical@topcon.nl; www.topcon.eu

**Topcon Deutschland GmbH**  
Giesslerallee 31; D-47877 Willich, Germany  
Phone: (+49) 2154 885 0; Fax: (+49) 2154 885 177  
E-mail: info@topcon.de; www.topcon.de

**Topcon Scandinavia A.B.**  
Neogatn 2; P.O. Box 25; 43151 Mölndal, Sweden  
Phone: (+46) 31 7109200; Fax: (+46) 31 7109249  
E-mail: medical@topcon.se; www.topcon.se

**Topcon Danmark**  
Praestemarksvej 25; 4000 Roskilde, Danmark  
Phone: (+45) 46 327500; Fax: (+45) 46 327555  
E-mail: info@topcondanmark.dk  
www.topcondanmark.dk

**Topcon España S.A.**  
HEAD OFFICE; Frederic Mompou, 5; 08960 Sant Just  
Desvern; Barcelona, Spain  
Phone: (+34) 93 4734057; Fax: (+34) 93 4191532  
E-mail: medica@topcon.es; www.topcon.es

**Topcon S.A.R.L.**  
HEAD OFFICE; 89, rue de Paris; 92585 Clichy, France  
Phone: (+33) 1 41069494; Fax: (+33) 1 47390251  
E-mail: topcon@topcon.fr; www.topcon.fr

**Topcon Italy**  
Viale dell' Industria 60; 20037 PADERNO DUGNANO;  
(MI) ITALY  
Phone: (+39) 02 9186671; Fax: (+39) 02 91081091  
E-mail: topconitaly@tiscali.it; www.topcon.it

**Topcon (Great Britain) Ltd.**  
Topcon House; Kennet Side; Bone Lane; Newbury  
Berkshire RG14 5PX; United Kingdom  
Phone: (+44) 1635 551120; Fax: (+44) 1635 551170  
E-mail: info@topcon.co.uk; www.topcon.co.uk

**Topcon Ireland**  
Unit 69, Western Parkway; Business Centre  
Lower Ballymount Road; Dublin 12  
Phone: (+353) 1460 0021; Fax: (+353) 1460 0129  
E-mail: topcon@indigo.ie